

CONECTOR POWER PWCPS PARA PANEL

SALIDA, BLANCO, 20A, 250V

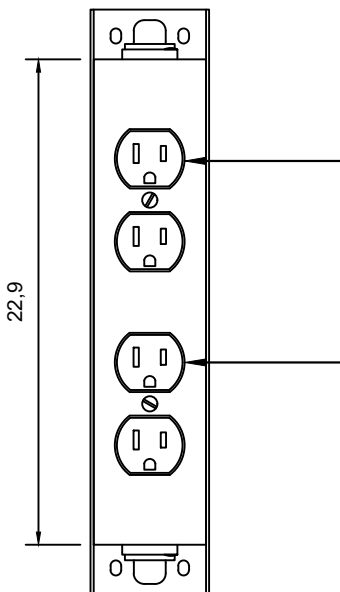
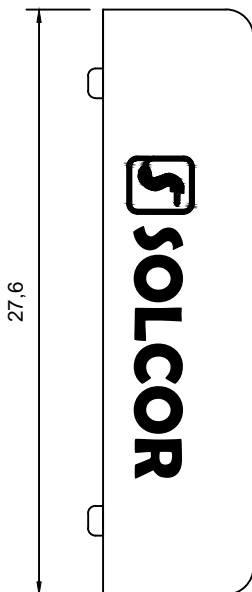
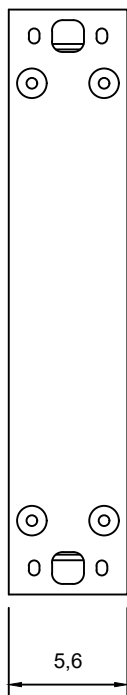

DOS CONTACTOS DOBLES 15A, 125/250V

NEMA 5-15R, FASE SIMPLE, DOS POLOS

CONECTOR POWER PWCPE PARA PANEL

SALIDA, AZUL, 20A, 250V

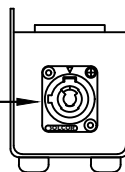

Extensiones Electricas y de Audio S.A. de C.V.

Acotacion: cm	Codigo:	MCEPWES		Escala:	Sin Escala
A MENOS QUE SE ESPECIFIQUE LO CONTRARIO TOLERANCIAS ±0.1	Descripcion:	MULTICONTACTO POWERCON ENTRADA Y SALIDA		Sistema:	
	Realizo:	RMF	2024.09.28		
	Revision 1:	RTC	2024.09.28	T Hoja:	A1
	Revision 2:				